



Bench Seating for 6



Drying Room

Canteen

## 12' Eco Welfare Unit

Canteen facilities for 6 with separate toilet and drying room. Incorporating auto voltage sensing generator charging technology.

Gross weight: 1800Kg  
Unladen weight: 1700Kg

The eco12 Incorporates environmentally friendly features to reduce emissions, maintenance, fuel consumption, generator hours and noise pollution.

LED lights, diesel heating & hot water means that the generator is run only to power 240 volt appliances or recharge batteries.

The Battery Condition Monitoring system automatically turns on & off the generator for charging and when the appliances are used.

This model takes the control of generator away from the operator ensuring the most economical solution available from our range.

### Construction Specification

- Walls:** Constructed from unique patented (2448660) high strength composite panels. Galvanised steel exterior, seamless GRP interior and high density foam insulation, provides rust free and washable surfaces.
- Roof:** Seamless insulated composite panel.
- Floor:** 15mm phenolic faced marine ply.
- Wheels:** 195R 14"
- Chassis:** Heavy duty galvanised steel.
- Axles:** Electric type approved hydraulic axle.
- Doors:** 3 x high security composite doors with 2 deadlocks.  
Double doors to generator with 2 deadlocks.
- Window:** Aluminium with security door locked internally with thumb turn deadlock.
- Lights:** EEC approved built in road lights with removable number plate brackets.



Wash Facilities



Diesel heating & 12V LED lighting



### In Summary

- ✓ Low in maintenance
- ✓ Low in emissions
- ✓ Low in fuel consumption
- ✓ Low in noise pollution
- ✓ Compliant with HSE regulations



# Specification

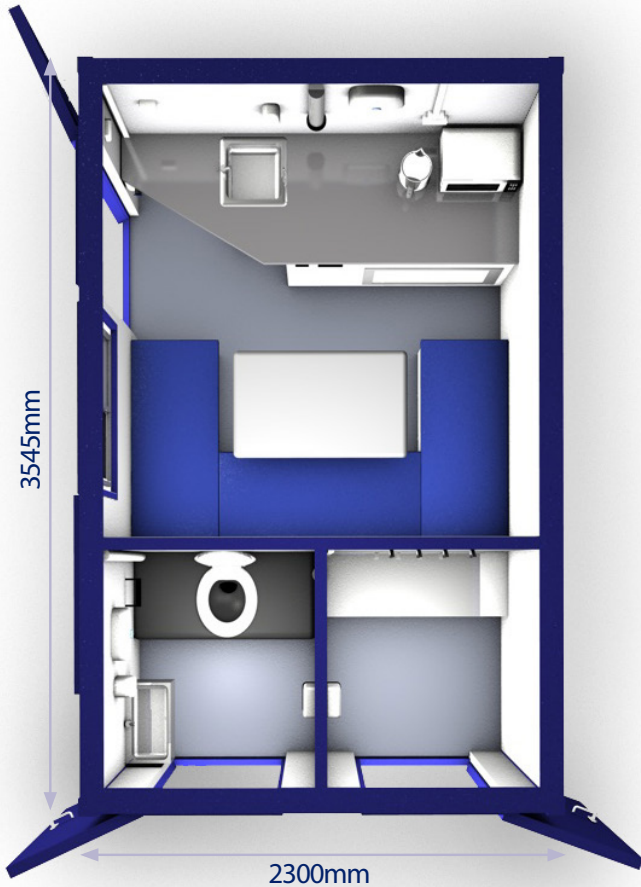

## Power

- High cycle AGM batteries
- Battery charger
- Battery Condition Monitor
- Invertor
- Diesel generator battery charger
- 12volt Hydraulic pump

## Canteen

- Bench seating for 10
- Thermostatically controlled hot water to stainless steel sink
- Eberspacher blown air
- thermostaically controlled heating
- Microwave and kettle run through invertors
- Durable embossed stainless steel worktop
- Soap dispenser
- Towel dispenser
- Stainless steel sink
- Waste container
- Drinking water container
- Cup dispenser
- PIR activated LED lighting
- Electrical certificate
- Carbon monoxide detector
- Diesel generator battery charger

## Drying Room

- 6 x coat hooks
- PIR activated 12 volt LED light
- Eberspächer 12volt control and heating system
- Blown air heating outlet

## WC

- Re-circulating flush tank toilet, 170 litre capacity
- Sink to wash up to forearm with thermostatically controlled running water
- Coat hook
- Soap dispenser
- Towel dispenser
- Toilet roll holder
- PIR activated LED lighting

## Energy & Cost Savings

Based on a 40hour week. Compared to a 6kva generator. Red diesel at 90p/litre.

- Diesel Saving 3,390ltrs / £3,050
- Maintenance saving £1,500
- CO2 emission saving 9,157kgs
- Engine hours saved 1,800
- Uses just 15ltrs diesel / week
- Low in noise pollution
- Long sustainability

Total saving per year £4,542 or £22,710 over 5 years at 100% usage  
 Total saving per year £3,179 or £15,897 over 5 years at 70% usage

Full energy saving presentation available on request.



Canteen



W/C



Diesel heating unit



Eberspacher control panel



Carbon Monoxide Detector